

# JUST ADD ARTS SYMPOSIUM

Strengthening Literacy and Social Emotional Learning Through Arts Integration

JUST ADD  
ARTS



## SYMPOSIUM SCHEDULE JULY 27-29

### Wednesday, July 27, 5:30-7:30 pm

**Ulrich Museum of Art**, Wichita State University, 1845 Fairmount St, Wichita, KS 67260

Museum Tour and Performance by ARISE Choir, Hors d'Oeuvres & Drinks

Free for registered participants and general public - space is limited

### Thursday Morning, July 28

**Rhatigan Student Center**, Wichita State University, 1845 Fairmount St #56, Wichita, KS 67260

- Morning session is free and open to the public until 11:00 am -

**8:00 am Agenda & swag bag pick-up for registrants**

**8:30 am Welcome**  
Spoken Word Performance  
Cydnee Reese, Arts Partners Teaching Artist

**9:00 am Keynote Address**  
Jamie Kasper, Director, Arts Education Partnership

**10:00 am Break**

**10:10 am Credit Union of America, Bradley Dyer**

**10:20 am Interactive Panel**  
Moderator:  
David Dik, National Executive Director, Young Audiences Arts for Learning

Panelists:

- Shawn Chastain, Executive Coordinator, Fine Arts, Wichita Public Schools
- Prisca Barnes, Founder/ CEO, Storytime Village
- Ellamonique Baccus, Executive Director, Arts Partners
- Kassie Misciewicz, Consultant, Focus 5 and Artistic Director, Trike Theatre
- Jamie Kasper, Director, Arts Education Partnership
- Dr. Tasha Parker, Ph.D., LSCSW, Principal and Founder, Institute of Development
- Rachel Straughn-Navarro, K-12 State Outreach Coordinator, Spencer Museum of Art
- Sue Trainor, DC/MD/VA Wolf Trap Master Teaching Artist
- Elaine Bernstorf, Professor of Music Education, Wichita State University, School of Fine Arts

**11:30 am Lunch on your own**

## Thursday Afternoon, July 28

- Afternoon session is open to registrants only -

12:30-2:30 pm Session 1\*

### **ACTING RIGHT: Building a Cooperative, Collaborative, Creative, Classroom Community Through Drama (K to 12th grade)**

Kassie Misciewicz, Consultant, Focus 5 and Artistic Director, Trike Theatre

This workshop takes the foundational elements of acting such as concentration, cooperation, and collaboration and creates a structured process, which can become the basis for effective classroom management every day. This engaging, step-by-step approach empowers students to take ownership of and be responsible for their own behavior. Learn how to help students build the skills necessary to establish a sense of self-control, accountability, and teambuilding in your classroom. This workshop is recommended for any classroom based in active, social, and cooperative learning.

### **"AHA!" READING: Developing Artful Strategies to Create Prior Knowledge (Pre-K to 2nd grade)**

Sue Trainor, DC/MD/VA Wolf Trap Master Teaching Artist

Explore and create multi-sensory music strategies designed to develop children's prior knowledge about story vocabulary, characters, setting, problem/solution. Children will experience the "aha!" feeling—a deeper understanding of and connection with story content as they apply their knowledge to new learning.

### **Visual Literacy: Seeing Between and Beyond the Lines**

Jana Erwin, Head of Education, Ulrich Museum of Art and  
Jennifer Ray, Photo Media Professor, Wichita State University

Learn how object-based learning and Visual Thinking Strategies can help build stronger learners and critical thinkers for the 21st century by helping students develop the skills they need to create meaning, collaborate, and express their own ideas, while encouraging reflection, analysis, and evaluative thinking. Participants will be guided by WSU photography professor and children's book author, Jennifer Ray, to create photographs using light-sensitive paper and apply Visual Thinking Strategies to practice social emotional skills in response to the created artwork.

### **Art Therapy for Self-Care (K to 12th grade)**

Jessie Muret, ATR, LSCSW, Creative Bliss Therapy

Learn about how creativity can be utilized as a component of self-care to maintain mental health. Participants will examine stress and participate in "stress-busting" Art Therapy directives using a variety of art media including paper, paint, items from nature, drawing materials and mosaic supplies. Participants will leave the workshop with ideas on how to incorporate creative healing in the work that they do with others as well as individual creative self-care.

\*Due to limited spaces, please participate in your assigned session.

# Thank You To Our Sponsors



Ulrich Museum of Art



The symposium is funded in part by a grant from the US Department of Education. However, the presenters and content do not necessarily represent the policy of the Department of Education, and you should not assume endorsement by the Federal Government.

### **Mask Making And Performance To Increase Social Emotional Learning (6th to 12th grade)**

Dr. Chinyere Grace Okafor, Professor of English and Women's Studies, Director of the Center for Women's Studies, Wichita State University and Twyla Smith, KS Wolf Trap and Arts Partners Teaching Artist

Struggling with social emotional learning in the classroom? This workshop is for you. Learn how to create masks with your students for self-reflection and expression specifically related to the KS Social Emotional and Character Development standards of self-awareness, self-management, social awareness, interpersonal skills, responsible decision making and problem solving. In this workshop, Dr. Chinyere Okafor will discuss the African tradition of mask performance and introduce masking as a tool for engaging students in social emotional learning. Participants will be guided by Arts Partners teaching artist, Twyla Smith, to create a simple mask that they will be able to make with their students and develop a mask performance.

**2:30 pm Transition/Snacks in Beggs Ballroom**

**2:45-4:45 pm Session 2\***

### **Connecting the Dots: Music, Language and Literacy (K to 5th grade)**

Amanda Vanausdall, Assistant Music Educator and Placement Coordinator, College of Fine Arts, Wichita State University

Join in exploring the many links between music, language, and literacy. This session will cover current research in arts integration. Attendees will look at ways to integrate music and children's literature, questioning techniques for engagement and comprehension, and purposeful movement activities that can fit into any classroom.

### **ACTING RIGHT: Building a Cooperative, Collaborative, Creative, Classroom Community Through Drama (K to 12th grade)**

Kassie Misciewicz, Consultant, Focus 5 and Artistic Director, Trike Theatre

This workshop takes the foundational elements of acting such as concentration, cooperation, and collaboration and creates a structured process, which can become the basis for effective classroom management every day. This engaging, step-by-step approach empowers students to take ownership of and be responsible for their own behavior. Learn how to help students build the skills necessary to establish a sense of self-control, accountability, and teambuilding in your classroom. This workshop is recommended for any classroom based in active, social, and cooperative learning.

### **Using Music, Art, and Dance to Increase Literacy and Social Emotional Skills (K to 2nd grade)**

Sherry Pfeifer, Allison Stucky, Jeremy Thomas, Cydnee Reese and Geli Chavez

Arts Partners' Artists to Authors Fellowship brought together the creative minds of local artists and educators to author and illustrate children's books that introduce young readers to the elements of a healthy community. Meet Arts Partners' newly published children's book authors. Learn how to use music, art, dance to increase literacy and the social emotional skills based on the books that you can immediately apply to your classroom.

### **Restorative Practices & The Arts (K to 12th grade)**

Rob Simon, Arts Partners Performing Artist and Restorative Justice Consultant

Discuss and strategize about "**The 5R's of Restorative Practices in a School Environment**" - Relationship, Respect, Responsibility, Repair, and Reintegration. Rob will employ storytelling and music to enhance the discussion and encourage participants to do the same in establishing restorative practices in schools and classrooms.

### **Creating Songs for the Early Childhood Classroom, No Experience Necessary! (Pre-K to 2nd grade)**

Aaron Fowler, Kansas Wolf Trap Master Teaching Artist, Arts Partners

The power of music surrounds us every day. It can bring us joy or move us to tears. It can also be a powerful tool in the classroom when used as a management technique with children. This unique tool can add novelty and fun to classroom management and transitions. Discover how to create simple songs and chants that will engage children while enhancing the flow of your classroom routine. Includes handout

**4:45 pm Closing**

\*Due to limited spaces, please participate in your assigned session.

**Friday, July 29**

**Rhatigan Student Center, Wichita State University, 1845 Fairmount St #56, Wichita, KS 67260**

- Friday sessions are open to registrants only -

**8:00 am Breakfast with the Experts: Meet Arts Partners and Wolf Trap Teaching Artists and learn about how you can bring their dynamic programs to your school. Learn about resources available through Credit Union of America.**

Geli Chavez  
Kay Alston

Aaron Fowler  
Twyla Smith

Shawn Reida  
Joyce Gedraitis

Denise Colborn  
Adam Payton

**9:00 am-12:00 pm Intensive Session 1\***

**ACTING RIGHT: Building a Cooperative, Collaborative, Creative, Classroom Community Through Drama (K to 12th grade)**

Kassie Misciewicz, Consultant, Focus 5 and Artistic Director, Trike Theatre

This workshop takes the foundational elements of acting such as concentration, cooperation, and collaboration and creates a structured process, which can become the basis for effective classroom management every day. This engaging, step-by-step approach empowers students to take ownership of and be responsible for their own behavior. Learn how to help students build the skills necessary to establish a sense of self-control, accountability, and teambuilding in your classroom. This workshop is recommended for any classroom based in active, social, and cooperative learning.

**Increasing Learning Motivation And Focus Through Movement (K to 12th grade)**

Denise Colborn, Arts Partners Performing Artist and Colborn Dance & Fitness Owner

Bring movement into your classroom to increase your students' focus, retention and understanding of curriculum content while having fun. Learn simple movement, relaxation, and meditation techniques that you can apply right away. These techniques are known to help students regulate their emotions, and access the frontal lobe responsible for planning, organization, logical thinking, reasoning, and managing emotions.

**"AHA!" READING: Developing Artful Strategies to Create Prior Knowledge (Pre-K to 2nd grade)**

Sue Trainor, DC/MD/VA Wolf Trap Master Teaching Artist

Explore and create multi-sensory music strategies designed to develop children's prior knowledge about story vocabulary, characters, setting, problem/solution. Children will experience the "aha!" feeling—a deeper understanding of and connection with story content as they apply their knowledge to new learning.

**Building Empathy: Putting Yourself in Others' Shoes Through Poetry and Movement (4th to 12th grade)**

Regina Klenjoski, MFA, Movement Educator and Choreographer, RKDC & Cydnee Reese, Author, Poet and Musician

This session will take students through a writing and movement experience using the children's book *A Lot of Miles* as inspiration. Experience a specific process to help students build awareness of themselves and others by understanding how to use their emotions to guide their thinking and actions. Workshop activities include poetry writing, movement games, partner and group work, and the opportunity for reflection. Participants will begin the session with introspective writing, led by Cydnee, that will allow them to explore the impact of words and how they relate to emotions using the medium of poetry. Participants will then work with Regina to learn movement exercises that strengthen the body-mind connection and use personal writing to inspire creative movement.

**Building Your SEL Artist Toolbox: Tips and Tricks for Your Day-to-Day Classroom (K to 12th grade)**

Rachel Straughn-Navarro, K-12 State Outreach Coordinator, Spencer Museum of Art; Colleen MacGilvray, Museum Educator, Spencer Museum of Art and Kristina Walker, Head of Education, Spencer Museum of Art

Experience and apply bite-sized activities and techniques for both personal well-being and artistic SEL in your classroom. Participants will leave with a mental toolbox full of ideas for brief and effective arts-SEL integrations to use in every classroom situation.

**12:00 pm Lunch on your own**

\*Due to limited spaces, please participate in your assigned session.

12:45 pm-3:45 pm

## Intensive Session 2\*

### **ACTING RIGHT: Building a Cooperative, Collaborative, Creative, Classroom Community Through Drama (K to 12th grade)**

Kassie Misciewicz, Consultant, Focus 5 and Artistic Director, Trike Theatre

This workshop takes the foundational elements of acting such as concentration, cooperation, and collaboration and creates a structured process, which can become the basis for effective classroom management every day. This engaging, step-by-step approach empowers students to take ownership of and be responsible for their own behavior. Learn how to help students build the skills necessary to establish a sense of self-control, accountability, and teambuilding in your classroom. This workshop is recommended for any classroom based in active, social, and cooperative learning.

### **Build Me a Story (K to 2nd grade)**

Kim Ratliff, Kansas City Young Audiences and KS/MO Kennedy Center Teaching Artist

Come prepared to move and get your creative juices flowing! Join Kim Ratliff as she presents a STEAM/Arts Integration approach that can transform your classroom and your students engagement in learning. This session will focus on the elements of storytelling, engineering and problem solving, and creative and inventive ways for your students to write their own stories!

### **Increasing Learning Motivation and Focus Through Movement (K to 12th grade)**

Denise Colborn, Arts Partners Performing Artist and Colborn Dance & Fitness Owner

Bring movement into your classroom to increase your students' focus, retention and understanding of curriculum content while having fun. Learn simple movement, relaxation, and meditation techniques that you can apply right away. These techniques are known to help students regulate their emotions, and access the frontal lobe responsible for planning, organization, logical thinking, reasoning, and managing emotions.

### **Creating Songs for the Early Childhood Classroom, No Experience Necessary! (Pre-K to 2nd grade)**

Aaron Fowler, Kansas Wolf Trap Master Teaching Artist, Arts Partners

The power of music surrounds us every day. It can bring us joy or move us to tears. It can also be a powerful tool in the classroom when used as a management technique with children. This unique tool can add novelty and fun to classroom management and transitions. Discover how to create simple songs and chants that will engage children while enhancing the flow of your classroom routine. Includes handout

### **Art Therapy -Visual Art Experience/Takeaway (K to 12th grade)**

Jessie Muret, ATR, LSCSW, Creative Bliss Therapy

Attendees will participate in hands on art making in this workshop. In the workshop time, we will be examining stress and participating in "stress-busting" Art Therapy directives. Through the experience, we will be learning about how creativity can be utilized in self-care to assist us in maintaining the all important mental health practice. We will use a variety of art media in this workshop experience including paper, paint, items from nature, drawing materials and mosaic supplies. Participants will leave the workshop with ideas on how to incorporate creative healing in the work that they do with others as well as individual creative self-care.

3:45 pm      Transition/Snacks in Beggs Ballroom

4:00 pm      **Bringing it all together\*: Reflection and Evaluation, certificates of participation distributed**  
\*Required for all participants

\*Due to limited spaces, please participate in your assigned session.

## Presenters

**Kay Alston** retired USD 259 teacher and Adjunct Instructor Butler Community College, is an experienced music educator, teacher, director and performer. She has had a variety of musical experiences in the K-12 schools, church, community and Junior Colleges. She loves to sing, prepare music programs, interact with students and other interested musicians and teachers. Kay's programs will engage your students and connect them to a variety of curriculum areas.

**Ellamonique Baccus** is an art therapist and the Executive Director of Arts Partners in Wichita. She earned her Master's degree in Art Therapy from The School of the Art Institute of Chicago and was a Licensed Clinical Professional Counselor in Chicago for over 10 years prior to relocating to Wichita. Ellamonique is also a professional artist, designing and implementing over 30 Public Art Projects that transform urban landscapes and promote community health through cross sector partnerships. She was trained in Renaissance Oil Painting at the Atelier Neo Medici in Monflanquin, France and received her BFA in Painting from Bowling Green State University. She has worked as an adjunct faculty member at Arkansas Baptist College and Elizabeth City State University teaching Art History and Art Therapy and lectured at Wichita State University. She is a fellow of the University of Chicago Booth School of Business and Chicago Urban League IMPACT program. In 2017, she developed the Wesley Children's Hospital Medical Art Therapy Program in Wichita. She also serves as an appointed member of the City of Wichita Design Council and Arts Council.

**Prisca Barnes** is the Founder/ CEO, Storytime Village, a nonprofit organization with a mission to serve low-income Kansas children and families. Since Storytime Village's beginning in 2009, she has worked to help underserved children thrive through partnerships that provide early childhood development, family engagement around reading, and access to books. Prisca is especially dedicated to improving the disparities in reading proficiency rates that exist by race and income in her state.

**Elaine Bernstorf** is a Professor of Music Education at Wichita State University, School of Fine Arts. Elaine received her Bachelor of Music Education, Master of Music Education, and a PhD in Communicative Disorders and Sciences from Wichita State University. As a professor and researcher, Dr. Bernstorf's specializations include elementary vocal music, special music education, early childhood arts education, speech pathology (especially in the areas of voice, fluency, and child language), literacy development, and curriculum development. Dr. Bernstorf is co-author of two editions of the book *The Music and Literacy Connection* (2004, 2014) published by NAFME (National Association for Music Education) through Roman and Littlefield. She has a book chapter in two publications: *Exceptional Music Pedagogy for Children with Exceptionalities International Perspectives* (2016) edited by VanderLinde-Blair and McCord; *Preparing Educators for Arts Integration: Placing Creativity at the Center of Learning* (2017) edited by Diaz and McKenna. She is also nationally recognized for her work with the Organization of American Kodály Educators.

**Shawn Chastain** is Executive Coordinator of Fine Arts for the Wichita Public Schools, supporting 300 faculty members. Prior to this position, Shawn spent 15 years in the choral classroom at Wichita's Charles Curtis Middle School and Heights High School. Chastain received his Bachelor's and Master's degrees from Wichita State University where he was a Presser Scholar. In addition to his educational responsibilities, Shawn is in his 23rd year as Music Coordinator/Adult & Youth Choir Director at Wichita's Calvary United Methodist Church, 21st season as Director of the Wichita Choral Society, and 11th Season as ARISE (African Americans Renewing Interest in Spirituals Ensemble) Choral Director. Shawn has also directed WSU's Kodaly Certification Adult Choral Ensemble and the Sedgwick County Jail's Men's Ensemble. Shawn is past president of the Kansas Choral Directors Association, WSU's Fine Arts Advisory Board/Friends of Fine Arts, and past chair of NAFME's Music Program Leaders Advisory Council.

**Geli Chavez** is a Wichita visual artist and Arts Partners teaching artist. She is the co-illustrator of the children's book, *A Lot of Miles*, with Taylor McQueary and Cydnee Reese. She has a degree in Graphic Design from Fort Hays State University. Geli strives to create work that resonates with many and always with concept in mind.

**Denise Colborn** is a visionary in the fitness and dance industry. She successfully launched a thriving fitness and dance company that helps clients incorporate exercise and proper nutrition into their daily lives. She also partners with school and community groups where she uses her knowledge to educate others on the importance of a healthy lifestyle and utilizes her art to help students learn.



**David Dik** was appointed National Executive Director of Young Audiences Arts for Learning in July 2010, the nation's largest arts in education network. Prior to this position, he served as the Managing Director of the Metropolitan Opera Guild, having also served as the Guild's Director of Education. David serves on the Leadership Team of the National Coalition for Core Arts Standards, Board of Directors for the Music-in-Education National Consortium, the Advisory Committee of the Arts Education Partnership (AEP), a trustee and executive committee member of the Potsdam College Foundation and a member of the Harvard Graduate School of Education Arts in Education Advisory Council. David's career began as a certified school music educator. David was recently appointed as a Technical Working Group Advisor for the Statewide Infrastructure Project for Arts Education in partnership with Americans for the Arts (AFTA) and the Education Commission of the States (ECS) and a member of the Windgate Advisory Board for Crystal Bridges Museum of American Art in Bentonville, Arkansas.

**Jana Erwin** is the Head of Education at the Ulrich Museum of Art at Wichita State University and is responsible for producing the Museum's public and academic programming, including artist talks, panel discussions, curriculum development, guided tours and in-gallery learning experiences for K-12 and college students.

**Aaron Fowler** is a Nationally Credentialed Teaching Artist with Young Audiences and is a Master Teaching Artist with Wolf Trap Early Learning Through the Arts. He is on the Kansas Arts on Tour roster with the Kansas Creative Arts Industries Commission. He is one of the original artists with Arts Partners joining the roster in 1998. Aaron is also the author of the children book series, *The Adventures of Bella and Choco* series. He currently serves as the President of AFM Local 1000 (Touring Musicians Union).

**Joyce Gedraitis** holds a Masters in Early Childhood Handicap, degree from Wichita State University. She has danced with folk dance groups all over the United States and in London, England. During the summer of 2009, Joyce went to Israel where she attended a 10-day summer course in Israeli folk dancing.

**Jamie Kasper**, as director of the Arts Education Partnership, works with over 100 partner organizations to support arts learning across the United States. Prior to joining Education Commission of the States, Jamie worked for Arts Education Collaborative in Pittsburgh and was previously the state arts curriculum advisor at the Pennsylvania Department of Education. Jamie is also an active musician who spends time on the weekends rehearsing or performing with various groups.

**Regina Klenjoski** is Choreographer, Artistic Director and Founder of Regina Klenjoski Dance Company, a dual-state (CA and KS) arts organization. Recognized by the Los Angeles Times as "a dynamic, graceful and indefatigable presence" she has created 40 works for RKDC in collaboration with numerous national and international artists in music, set design, costume and film. Her work has been commissioned for stage, site-specific locations, film and educational institutions, and for the past 29 years, has been presented throughout Southern California, the Midwest, New York and internationally in Paris and at Festival d'Avignon. Klenjoski's uncompromising dedication to arts education is most notable in the ongoing non-competitive dance education programming she began with the Torrance Cultural Services Division which has seen over 23,000 participants since 1999. She has been an adjunct professor in dance at Wichita State University for the past 6 years, teaching improvisation, modern dance technique and somatics. She is a three-time National Endowment for the Arts grantee, and currently lives, creates, and teaches in Wichita, KS.

**Colleen MacGilvray** is a museum education professional with a background in environmental education and informal science education. Currently, she works at the Spencer Museum of Art at the University of Kansas as the PEAK Program Coordinator.

**Kassie Misiewicz** (Artistic Director & Founder of Trike Theatre) is a professional theatre for youth director and educator. Kassie earned her MFA in Theatre for Youth from Arizona State University and a BA in Theatre from University of Notre Dame. Before starting Trike Theatre in 2008, Kassie was the co-founder and first artistic director of TheatreSquared in Fayetteville, AR, Director of Education Outreach at Seattle Children's Theatre and Associate Artistic Director at First Stage Children's Theatre in Milwaukee. Currently, she is a national arts integration consultant with Focus5 and a national teaching artist with the John F. Kennedy Center for the Performing Arts in Washington, D.C. Kassie loves to travel with her family and have spontaneous dance parties in the kitchen.

**Jessie Muret** is a Registered Art Therapist and Licensed Clinical Social Worker who has dedicated her career to bringing creative healing to communities. She earned her Master of Science in Art Therapy from Emporia State University in 2004 and her Master of Social Work from Wichita State University in 2011. Throughout her career, Jessie has provided specialized trauma informed services in Art Therapy to at-risk youth & children, survivors of abuse & neglect, sexual assault survivors, human trafficking survivors and has provided treatment for various mental health needs. In 2016, Jessie started Creative Bliss Therapy, LLC, Wichita's premiere Art Therapy private practice and is a proud member of the American Art Therapy Association and the Kansas Art Therapy Association. Since then, she has presented at various professional conferences, workshops and is a Field Instructor for Universities across Kansas as well as a Clinical Supervisor in Social Work approved by the Kansas Behavioral Sciences Regulatory Board. Jessie loves creative ventures of all sorts and has a passion for the arts, travel, late nights around the fire with friends & family and nature.

**Dr. Chinyere Grace Okafor** is a Wichita State University Professor of English and Women's Studies, chair of Women's Studies, and Director of the Center for Women's Studies. Her degrees in English, Theater, and African Studies culminating in her postdoctoral at Cornell University on the poetics and politics of gender inform her research on African masking. Her research on masking is interdisciplinary intersecting African orature, feminist and cultural studies with the organizing principle of masking as art in performance. She has numerous articles in journals and edited volumes including seven on African masking. She has authored eight books including two on masking: *Gender, Performance and Communication – African Ikeji Mask Festivals Aro and Diaspora* (2017) and *Ikeji Festival Theater of the Aro and Diaspora: Gender, Mask and Communication* (2015).

**Dr. Tasha Parker**, PhD, LSCSW, MPA, ACHT, is a Clinical Social Worker and Principal Evaluator for the Institute of Development. Dr. Tasha Parker earned her Master of Public Administration, Master of Social Work and her Ph.D in Community Psychology from Wichita State University. Her expertise is in trauma and resiliency informed systems with special interest in ACEs, prevention, criminal and social justice, and diversity and inclusion. She believes that in order to resolve social problems, we must accurately assess and define all contributing factors.

**Adam Payton** is the STEAM Education Manager for Arts Partners. He earned his Master's degree in Mechanical Engineering from Wichita State University. Adam holds two Bachelor's degrees one in Mechanical Engineering and the other in Electrical Engineering. He works with professional artists to develop and implement STEAM programs for Preschool-12th grade students that focus on academic improvement and community development.

**Sherry Pfeifer** began teaching high school English, journalism, and speech in August of 1990 and has been at it ever since. In her 32 years, Sherry has also advised the high school newspaper and the literary arts magazine as well as worked as an assistant debate and forensics coach, a soccer team manager, student advisor, teacher mentor, community volunteer, and dual credit speech instructor at Newman University. Sherry was nominated by her peers and awarded the 2018 Excellence in Teaching Award for Maize High School. She plans to retire from public education in 2022 and continue teaching in the private school sector. She has earned a B.A. in Communication with minors in journalism and speech; a B.S. in Secondary Education with certifications in English, journalism, and speech; and a M.A. in Literature and the English language. She was recently inducted into the Kansas Teacher's Hall of Fame Class of 2022.

**Kim Ratliff** feels passionately about arts integration as a daily practice in every classroom. Her unique perception comes from wearing two hats simultaneously for three decades: her teacher hat and her performer's hat. During her 30 years as a career elementary school teacher, Kim has incorporated the arts across the curriculum. To do that, she uses concepts developed from 15 years as a teaching artist with Kansas City Young Audiences. As an educator, Kim has been selected to participate in arts integration training through the Kennedy Center and presented at national Project Lead the Way conferences. She received her bachelor's degrees from the University of Kansas and the University of St. Mary and a master's degree in education from the University of St. Mary, where she was on the Dean's List and named Outstanding Senior. Kim was very honored to be nominated as a Shawnee Mission Teacher of the Year. Her background as an artist includes studying at the American Academy of Dramatic Arts and the Groundling Theater. While performing in Los Angeles, Kim did theater, commercial and industrial work, but her true love was found in improvisational comedy. Working with KCYA for the past 15 years Kim's dramatic storytelling has been well received and performed hundreds of times. Her unique presentation breaks the fourth wall and requires active participation with her audiences.



**Jennifer Ray** is the Associate Director and Associate Professor of Photo Media at Wichita State University. Her photographic work is included in the collections of the Museum of Fine Arts Houston, the Museum of Contemporary Photography, and the Kinsey Institute, and has been exhibited at the RISD Museum of Art, the Chelsea Art Museum, the Museum of Contemporary Photography, Hyde Park Art Center, and Chicago Cultural Center, among other venues. Jennifer's work was included in the *Collector's Guide to New Art Photography*, published by Humble Arts Foundation. Prior to coming to WSU, she taught at Oberlin College, Columbia College, and the University of Illinois at Chicago. Jennifer is the co-illustrator of the children's book *Crabbylegs and the 3 Shells*, created during the 2022 Artists to Authors Fellowship.

**Cydnee A. Reese** is a multi-genre writer with a passion for the arts and charity. She is a singer-songwriter (Cydnée Alyxzan) who has written for and collaborated with artists from 6 different countries and was a semi-finalist in the International Songwriting Competition. As a poet (Wanderer), she has published a collection of poetry entitled *Ebony Blankets: A Collection of Poems by the Artist Called Wanderer*; was editor of *Dancing in the Presence of Men: A Book of Love & Lovers* by world-renowned poet Joyce Lee; she will release a children's poetry book in July of '22 and she has spoken and performed at various conferences and events including opening for author and speaker Megan Fate Marshman. In performance poetry, she has won poetry slams across the United States including scoring multiple perfect rounds and "winning the room" at the Women of the World Poetry Slam. Cydnee A. Reese was a semi-finalist in the AITAF 2022 Bridge Award for her work as a playwright. Her original play, *The Feminist*, is set for a staged reading in the summer of '22. In addition to her writing, she founded the nonprofit Wanderer Speaks United to utilize art to raise awareness of and funds for those in need.

**Shawn Reida** has been entertaining audiences professionally for close to 30 years. His programs are more than just magic as he works to create and present programs that meet the curriculum and theme requirements of the classroom.

**Esther Runck** is the Education Program Manager for Arts Partners. She has 12 years of experience teaching in the classroom, as well as 3 years as an instructional coach. She received her bachelor's degree in Elementary Education and her master's degree in Educational Leadership. She has worked in both the parochial and public-school systems teaching and mentoring educators and students from K-12th grade and has a huge passion to re-ignite purpose and joy in teachers and to peak curiosity in students to develop a love for life-long learning. Esther is also a freelance artist who believes integrating the arts organically promotes social/emotional interaction and rigorous critical thinking skills connecting students to be positive and vital contributors to their communities.

**Rob Simon** is an experienced performer/trainer/consultant who has worked with school systems and various other agencies from coast to coast. He is a former junior high social studies teacher, and also spent 12 years as a K-12 teaching specialist in a Drug and Violence Free program for schools and communities. With a masters degree in communication, Rob is also a long-time singer/songwriter who uses music as a primary tool in his work.

**Twyla Smith** is a professional teaching artist, specializing in dance and storytelling. She has worked with Arts Partners Wichita for more than 20 years, working with ages pre-K through adult. She is also a nationally certified Wolf Trap and Baby ArtsPlay teaching artist. Twyla has successfully integrated art and dance into the lives of thousands of young people.

**Rachel Straughn-Navarro** has a PhD in Art Education from the University of Missouri and is currently the Schools and Educator Engagement Coordinator at the Spencer Museum of Art at the University of Kansas. Rachel is also a lecturer in KU's Museum Studies department and won Art Museum Educator of the Year from the Missouri Art Education Association in 2018. Rachel specializes in university art museum public practice and K-12 teacher professional development.

**Allison Stucky** earned a BA in Art Education from Wichita State University in 1996, and a Master of Arts in Teaching degree from Saint Mary's College in 2003. She has been teaching K-12 Art for the past 23 years in both rural and urban districts in Kansas. Currently teaching at Riverside Leadership Magnet Elementary School in Wichita, Allison was the runner-up for USD #259 Specials Distinguished Teacher Award in 2019. Allison believes that through art, children have the outlet to find their unique voice, develop crucial problem-solving skills and experience autonomy. Along with teaching art, she has showcased her art work in a variety of exhibitions in Kansas City and Wichita. *Come Outside and Play* is Allison's second book illustration project having completed the illustrations for *Brain Awakes*, 2020.

**Jeremy Thomas** is a musician and Arts Partners teaching artist. He is a Wichita Public Schools Music teacher at Jackson Elementary. Jeremy is the author of the children's book, *Crabbylegs and the 3 Shells* illustrated by Jennifer Ray and Irma Puskarevic. His goal is to show children that music can be an outlet to help you through anything in life.

**Sue Trainor** is a Wolf Trap Master Teaching Artist working in the Washington, DC, Virginia and Maryland areas. She is a musician and performing-songwriter with a gift for stirring-up enthusiasm and creativity. Sue has been a Wolf Trap Teaching Artist since 2003, bringing professional development residencies into preschool and kindergarten classrooms, providing professional development workshops for early childhood educators and training for other teaching artists. Sue was named 2014 Artist of the Year by Young Audiences of Maryland for her arts-in-education work, which includes her role as lead teaching artist with Maryland Wolf Trap, Arts Integration Facilitator at a Title 1 school, and her residency programs in elementary, secondary, and special needs classrooms. Her most recent recording, "In Our Own Words," won the Wammie Award from the Washington Area Music Association for Best CD for Children. Sue received her bachelor's degree in anthropology from Lawrence University.

**Amanda Vanausdall** received her BME and MME in Special Music Education as well as her OAKE Kodály certification all from Wichita State University. She taught K-5 elementary music in Wichita Public schools from 2013-2022 and now serves as an Assistant Music Educator and Placement Coordinator in the College of Fine Arts at Wichita State University. Amanda serves in leadership roles with the Kansas State Music Educators Association as Special Needs Co-Chair, and as a member of the Organization of American Kodály Educators Equity Committee. She is currently pursuing a doctoral degree in Communication Sciences and Disorders at Wichita State University.

**Kristina Walker** has been with the Spencer Museum of Art at the University of Kansas in Lawrence for 25 years. As Director of Education since 2004, Walker oversees the development, production, and evaluation of interpretative materials and experiences that engage visitors with the Museum's collection and special exhibitions. Her current focus is on developing strategies for incorporating emerging technologies into interpretive materials and strengthening engagement with Youth and Family audiences and University and College students. She holds a BFA in Art History and a MA in Visual Arts Education from the University of Kansas.

# JUST ADD ARTS SYMPOSIUM

Strengthening Literacy and Social Emotional Learning Through Arts Integration

JUST ADD ARTS



An Affiliate of Young Audiences Arts for Learning

KANSAS WOLF TRAP INSTITUTE FOR EARLY LEARNING THROUGH THE ARTS

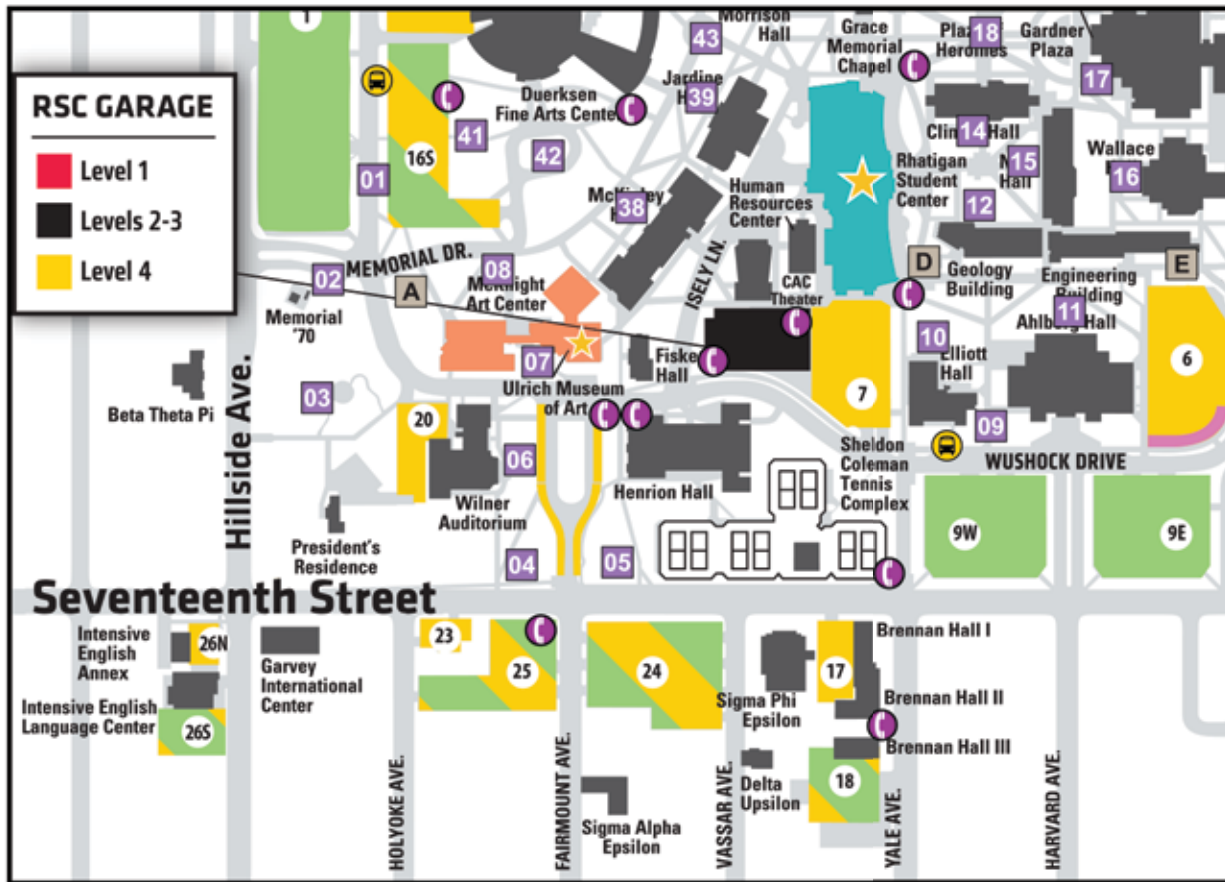

## PARKING LOTS

	STUDENT AND VISITOR		OPEN PARKING
	FACULTY, STAFF, AND VISITOR		RESERVED PARKING
	STUDENT, FACULTY, STAFF, AND VISITOR		COMMUNITY YMCA USERS ONLY M-F, 7 AM - 5 PM
	RESERVED CLINIC PARKING		HOURLY PARKING Additional Cost Required

- Symposium Venue
- Reception Venue

# Rhatigan Map

## SECOND FLOOR

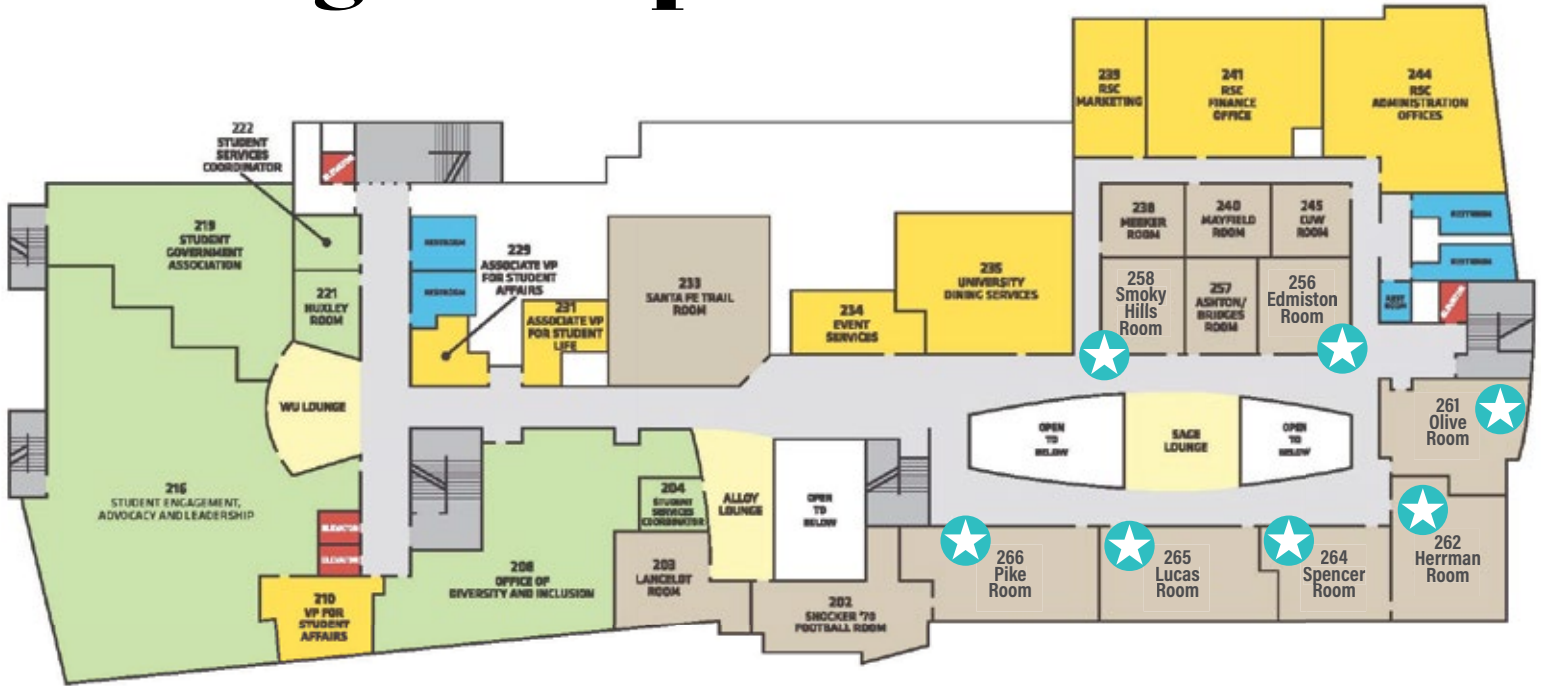

- STUDENT SERVICES
- STAIRS
- MEETING ROOMS
- ELEVATORS
- OFFICES
- RESTROOMS
- LOUNGES

## THIRD FLOOR

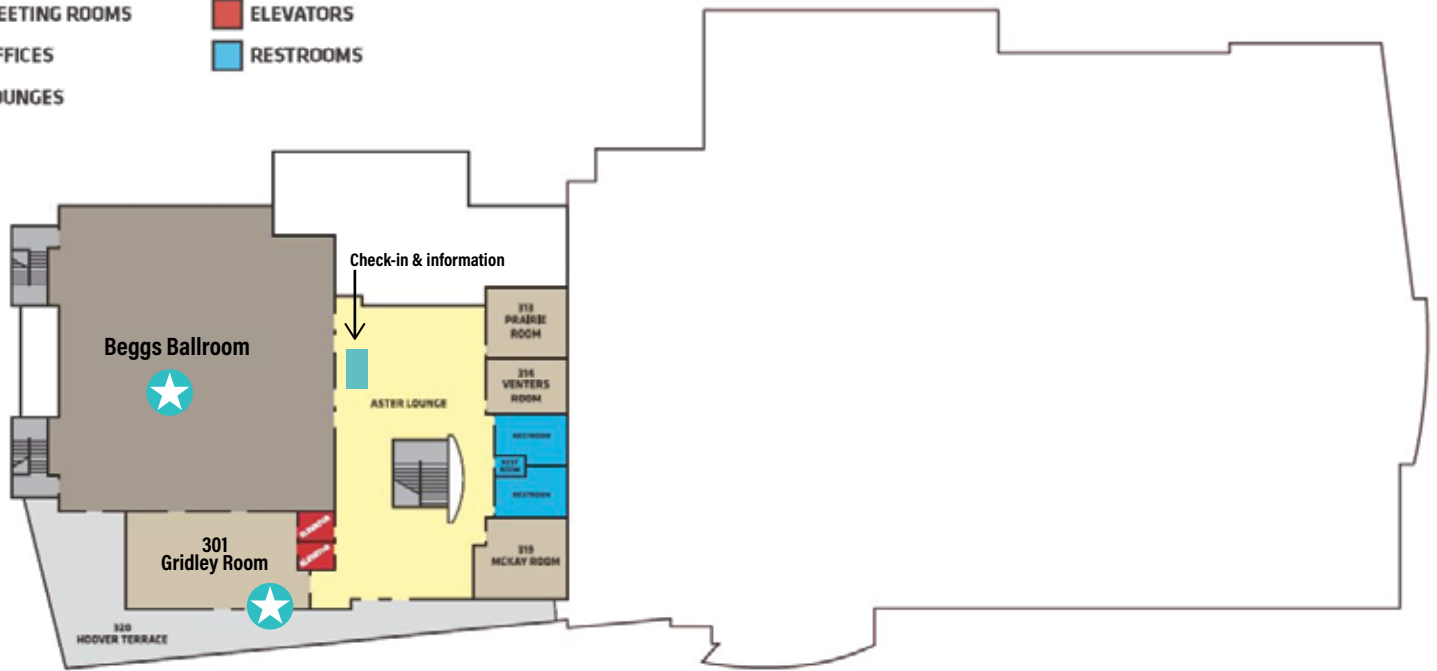

- BEGGS BALLROOM
- STAIRS
- HOOVER TERRACE
- ELEVATORS
- MEETING ROOMS
- RESTROOMS
- LOUNGES



**Session rooms**

# Rhatigan Map

## Dining Options

### LOWER LEVEL



### FIRST FLOOR

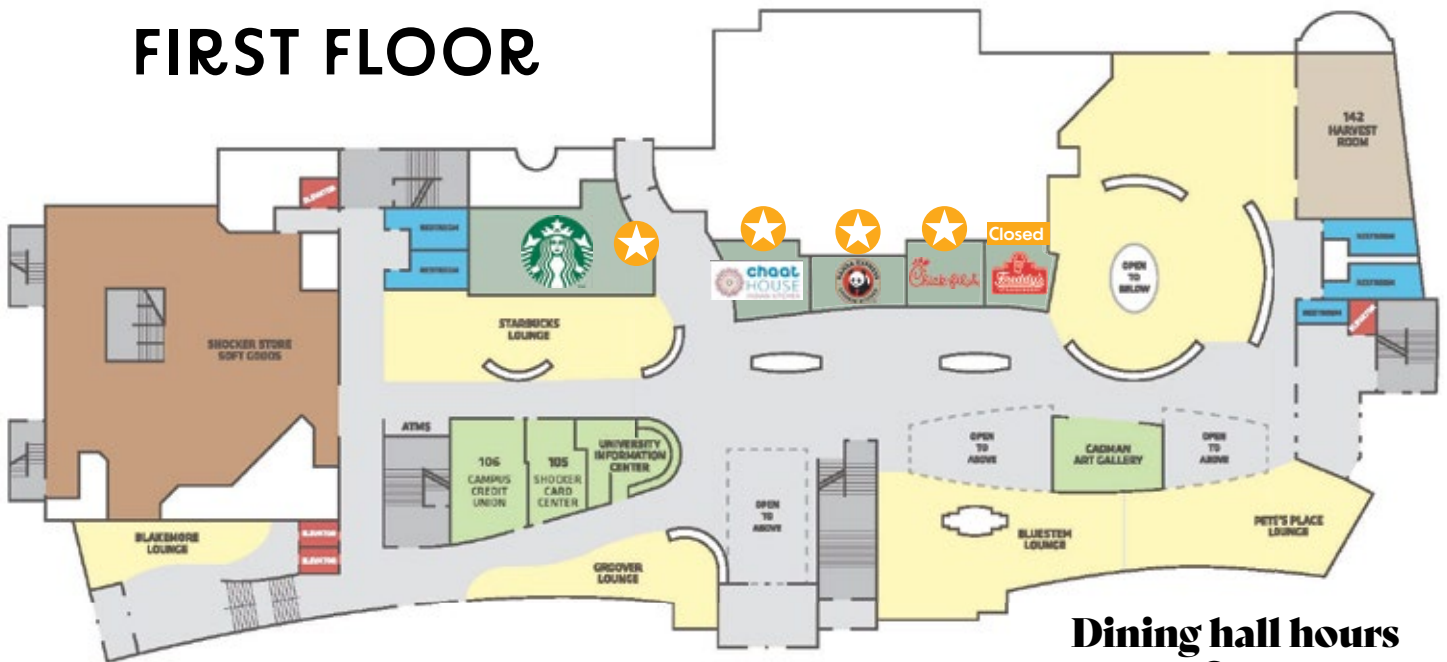

- |                         |           |
|-------------------------|-----------|
| SHOCKER STORE           | LOUNGES   |
| FOOD                    | STAIRS    |
| STUDENT SERVICES/RETAIL | ELEVATORS |
| MEETING ROOMS           | RESTROOMS |

**Dining hall hours**  
 7 am - 9 am  
 11 am - 1 pm

**Shocker Sports Grill Hours**  
 10 am - 7 pm

**Starbucks hours**  
 7:30 am - 5 pm



**Dining Options**